





Name: \_\_\_\_\_

ID: A

\_\_\_ 15. What is the surface area of a box with no lid that is 75 cm long, 0.4 m wide, and 200 mm high?

- a. 7600 cm<sup>2</sup>
- b. 10 600 cm<sup>2</sup>
- c. 30 220 cm<sup>2</sup>
- d. 5700 cm<sup>2</sup>

\_\_\_ 16. A square-based pyramid has a base length of 10 feet, a height of 45 inches, and a slant length of 3 yards. What is the surface area, including the base?

- a. 175 ft<sup>2</sup>
- b. 337.5 ft<sup>2</sup>
- c. 280 ft<sup>2</sup>
- d. 200 ft<sup>2</sup>

\_\_\_ 17. How many mL are in 1 cup?

- a. 100 mL
- b. 250 mL
- c. 300 mL
- d. 500 mL

\_\_\_ 18. Find the volume of the rectangular prism below, in in<sup>3</sup>.

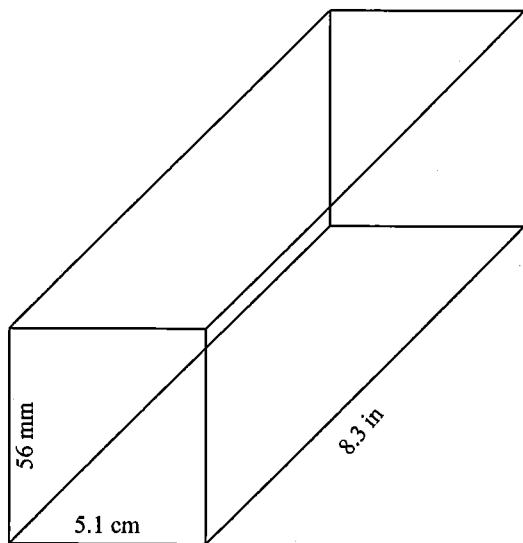

- a. 36.5 in<sup>3</sup>
- b. 143.6 in<sup>3</sup>
- c. 234.7 in<sup>3</sup>
- d. 39.3 in<sup>3</sup>

\_\_\_ 19. How many pints are in 13.9 quarts?

- a. 29.8 pints
- b. 7.0 pints
- c. 55.6 pints
- d. 27.8 pints



**Problem**

1. a) Calculate the amount of baseboard that will be needed to finish the room below.
- b) If you can buy baseboard only in whole feet, how much will it cost for the room if baseboard costs \$1.64/foot?

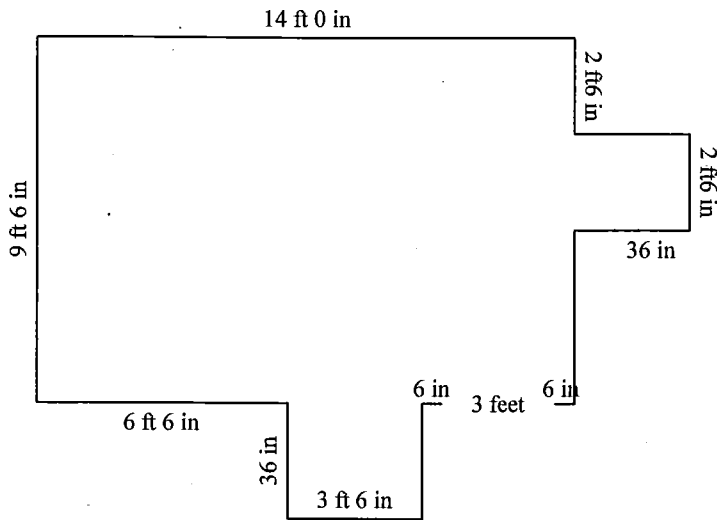

2. What is the perimeter of this figure?

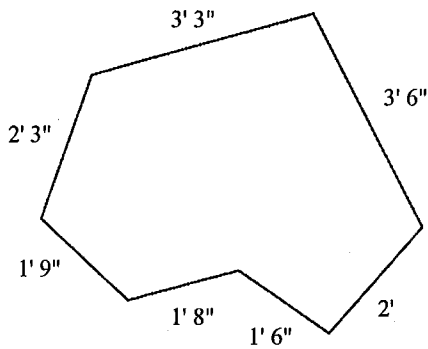

Name: \_\_\_\_\_

ID: A

3. A room measures 12'8" by 11'3". Carpet costs \$30.49/m<sup>2</sup>. If you must purchase 5% extra carpet to account for mistakes and waste, what will it cost to carpet the room?
4. A garden measuring 7 m by 6 m is to be covered in 15 cm of topsoil. Bags of topsoil cost \$7.99 per bag and hold 5 ft<sup>3</sup> of topsoil. How much will the topsoil for this garden cost?
5. What holds more, a 1.5-L bottle of pop or 6, 8-fl oz cans of pop? (Hint: 1 fl oz = 30 mL.)